



ATD-7040 MIG WELDING CART OWNER'S MANUAL



Features:

- Heavy-duty steel construction
- (2) storage shelves for accessories
- Built-in cylinder rack with safety chain
- Cable holders for torch and ground cables

Specifications:

- (2) 7-1/4" rubber wheels and (2) 3 x 3/4" swivel casters
- Top Shelf - 19.48" x 12.99"
- Overall Cart Size: 29.92" L x 13.38" W x 30.7" H
- Weight: 35 lbs.
- Weight Capacity - 150 lbs.

WARNING - PLEASE READ CAREFULLY TO AVOID INJURY!

1. The ATD-7040 cart is designed to carry one gas cylinder only for use with mig welding. Use caution when handling compressed gas cylinders and use only in the upright position. Use the provided chains to secure the cylinder at the top and the bottom as tightly as possible.
2. The ATD-7040 cart is designed to roll easily on flat surfaces and should not be used on inclined surfaces.
3. Use caution when moving your ATD-7040 cart as the weight of the welder will cause the cart to be top heavy.
4. Do not pull cart by the welder leads, as this could cause the cart to tip over.
5. Do not attempt to weld to the gas cylinder and do not fasten ground leads to your ATD-7040 welding cart, thus completing the circuit, as that could cause the mig gun to arc unexpectedly.
6. Failure to follow precautions and common sense could cause serious injury.

ASSEMBLY

1. Slide axle through support tube on bottom shelf (#1). Slip washer over both ends of axle, fit wheels onto axle and insert cotter pins.
2. Install casters to front of shelf (#1) using 4 hex head screws and washers to one side of shelf and 4 lock washers and hex nuts to the other side of shelf. Finger tighten only until all steps are complete.
3. Add vertical support (#2) to bottom of shelf (#1). Fasten through center hole of vertical support first, then fasten through side holes in bottom of vertical support.
4. Fasten side support rails (#3) to bottom shelf (#1). Add center shelf (#4) with flanges up. Start by fastening center hole towards rear of shelf then holes in rear of shelf, finally front side holes to side support rails.
5. Fasten top shelf (#5) in similar fashion, but include brackets (#6) for cord storage to top front holes in side support rails. Now tighten ALL fasteners and casters.

ATD[®]

ATD-7040

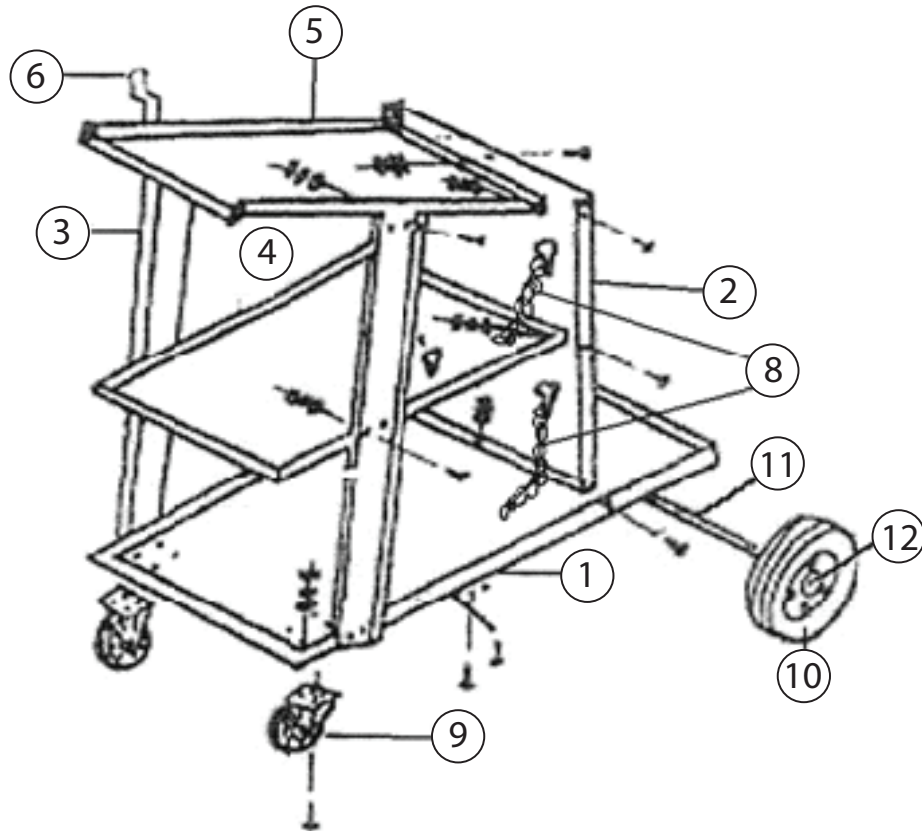

ITEM#	ORDERING PART#	PART DESCRIPTION
1	PRT7040-01	BOTTOM SHELF W/AXLE TUBE & WASHERS
2	PRT7040-02	VERTICAL SUPPORT PANEL
3	PRT7040-03	SIDE SUPPORT RAIL
4	PRT7040-04	CENTER SHELF (ALL SIDES FLANGED)
5	PRT7040-05	TOP SHELF (3 SIDES FLANGED)
6	PRT7040-06	BRACKETS FOR TORCH ASSY
7	PRT7040-07	HARDWARE (NOT PICTURED)
8	PRT7040-08	CHAIN
9	PRT7040-09	FRONT CASTERS
10	PRT7040-10	REAR WHEELS
11	PRT7040-11	AXLE
12	PRT7040-12	REAR WHEEL BUSHING

Top shelf: 19.48" x 12.99" (495mm x 330mm)
 Middle Shelf: 16.92" x 12.99" (430mm x 330mm)
 Bottom Shelf: 29.92" x 13.18" (760mm x 335mm)